



Features

Eco-Friendly Refrigerant

R290 refrigerant with a global warming potential (GWP) of 3

Cabinet Capacity

Internal area of 4.84ft³ with one (1) heavy-gauge wire shelf — adjustable in 1/2" increments using stainless steel pilasters

Refrigerated Countertop Compartment

Includes four (4) 1/6 size steel pans with covers and pan adapters

High-Efficiency Refrigeration System

Forced air circulation provides uniform temperature throughout the cabinet

Easy to Clean

Aluminum interior, coved corners, finished edges, removable shelves, cutting board, and lower compartment crumb tray for simple cleaning

Stainless Steel Exterior

Galvanized back and bottom to reduce the risk of corrosion

Heavy-Duty Soft Casters

Secured to a 12 gauge steel base to ensure years of worry-free operation

Stainless Steel Exterior

Galvanized back and bottom to reduce the risk of corrosion

Elevated Refrigerated Rail

Elevated rail holds up to five (5) 3-1/2 quart jars and positions key ingredients closer to the crew

Removable 8.5" Cutting Board

8.5" polyethylene cutting board provides a large durable work surface

High-Strength Doors

Heavy-duty, stainless steel doors are assembled using high-load brackets for long lasting durability

Magnetic 'Thermo Rubber' Gaskets

Heavy-duty, stainless steel doors with magnetic 'Thermo Rubber' gaskets ensure an air-tight cabinet

High-Density Insulation

Foamed-in-place, CFC-free polyurethane insulation for maximum strength, rigidity, and insulation

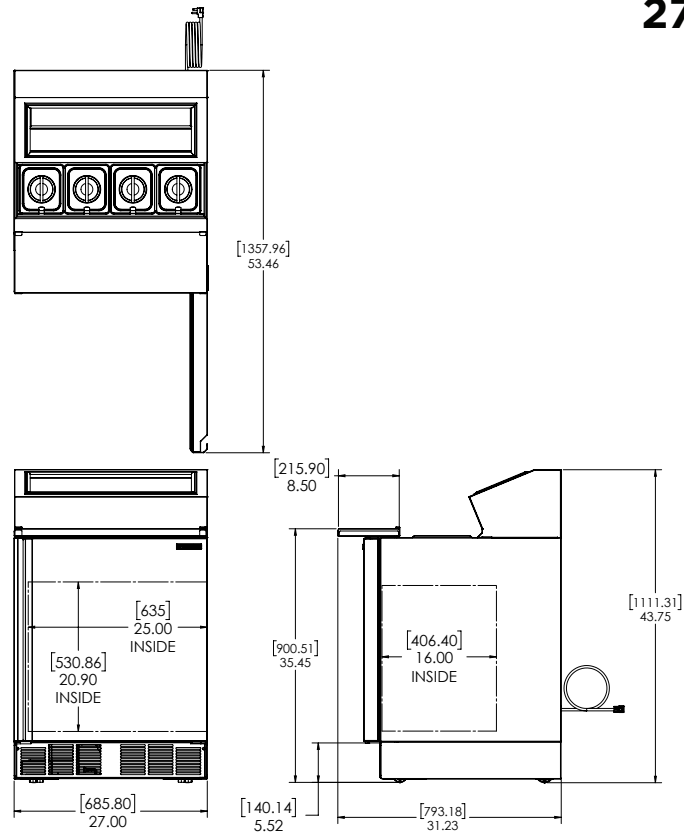

Technical Specifications

Electrical Requirements	115v/60hz/1ph/2.25A/NEMA 5-15P Plug
Product Dimensions	27"W x 43.75"H x 31.23"D (68.58cm x 111.13cm x 79.32cm)
Product Weight	190lbs (86.18kg)
Shipping Dimensions	32"W x 51"H x 37"D (81.28cm x 129.54cm x 93.98cm)
Shipping Weight	205lbs (92.99kg)
Shipping Cubic Dimensions	34.94ft ³ (.99m ³)
Temperature Range	36 to 40 (2.2 to 4.4°C)
Refrigerant	R290
Charge Level	4.23oz (120 grams)
Insulation	Foamed-in-place, CFC-free polyurethane

Exterior Construction	Stainless steel exterior with galvanized back and bottom
Interior Construction	Aluminum interior with coved corners and finished edges
Doors	One (1) right-hand swing door
Pan Well Capacity	Four (4) 1/6 size pans, adapters included
Rail Capacity	Five (5) 3-1/2 quart food jars
Internal Capacity	4.84ft ³
Rail Temperature	45 to 55°F
Door Gasket	Santoprene™
Shelves	Two (2) heavy-gauge wire shelves
Casters	Four (4) 2" heavy-duty soft casters, two (2) swivel and two (2) fixed
Certifications	ETL Safety, ETL Sanitation
Warranty	1-year parts and labor, 5-year compressor (part only)

Model Number	Description
SKRNB27-ESUS5	Fountainette, 27", 115v/60hz/1ph, single right-hand swing door, 8.5" cutting board, 2" heavy-duty low profile casters, NEMA 5-15P

To learn more about **Refrigerator**, visit silverking.com