

# How to Update Software on IDC Red



## Index:

**Obtaining Software:** Slide 2

**Updating During Installation:** Slides 3-7

**Updating After installation:** Slides 8-14

**Resetting Ratio if updating from 0.0.52 or below:** Slides 15-19



A Marmon / Berkshire Hathaway Company



# Tools Needed

- USB with the latest Software version
  - **Note:** it is recommended to have the latest IDC Red software version prior to arriving on site. The latest IDC Red software version can be found at <https://www.cornelius.com/IDC-Red/>. Download the latest software version and transfer to a USB. Do not open the file, copy from recent downloads and paste to your USB or click and drag from recent downloads to your USB.

# How to Update Software During Installation



A Marmon / Berkshire Hathaway Company



# Software Update (During Installation)

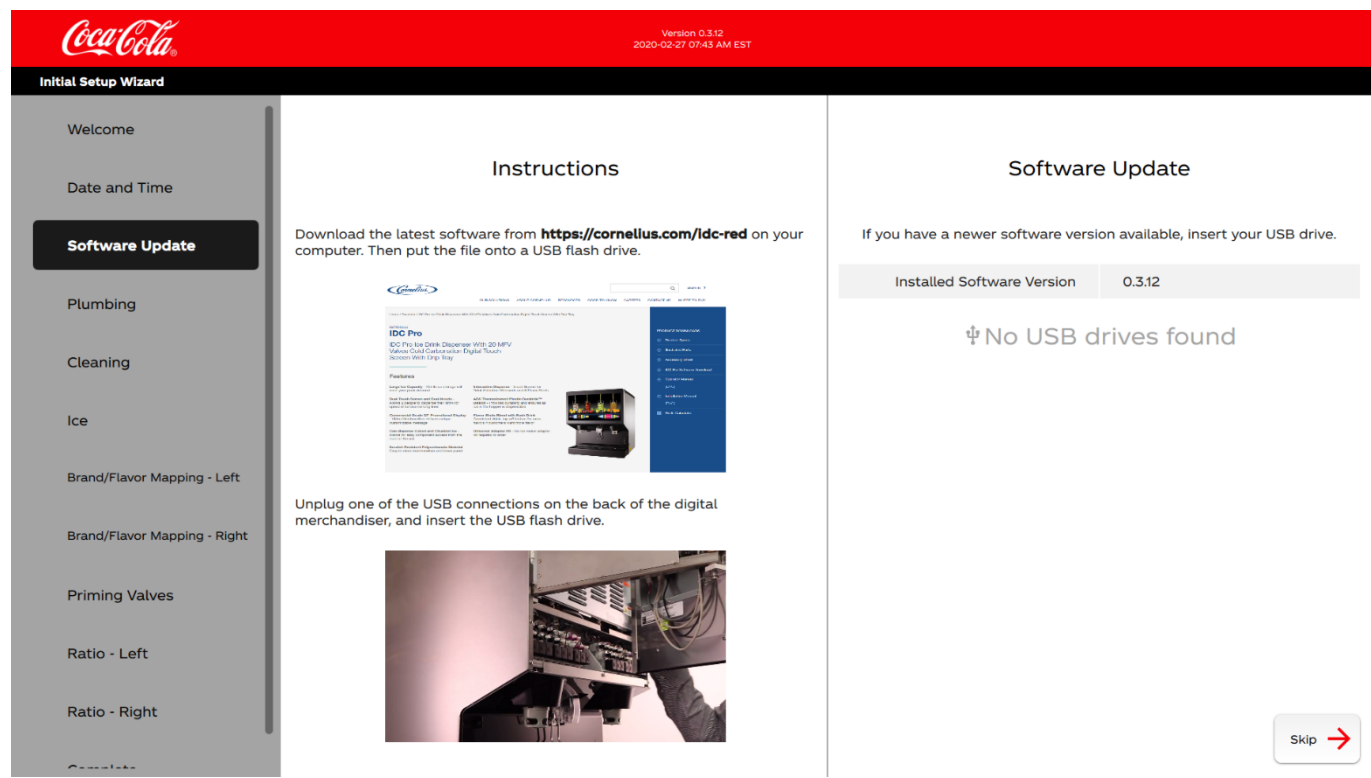

1. Select SOFTWARE UPDATE
2. Confirm current software version - this can be found on the right side of the screen under Software Update

# Software Update Cont.

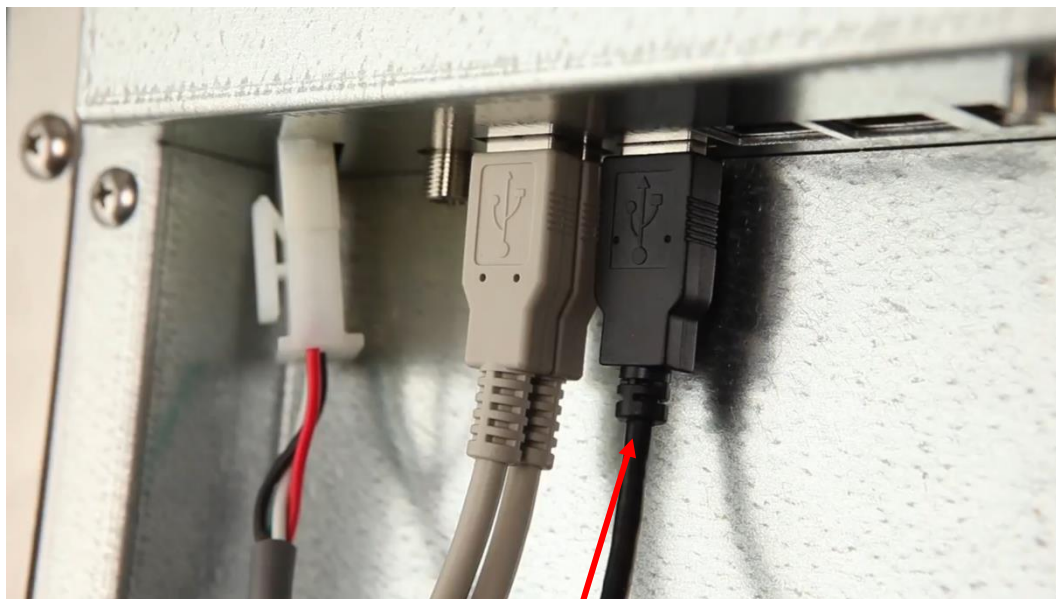

3. Remove the ADA USB cable. Note: there will be three black USB cables. The ADA USB cable will have a yellow stripe around it.

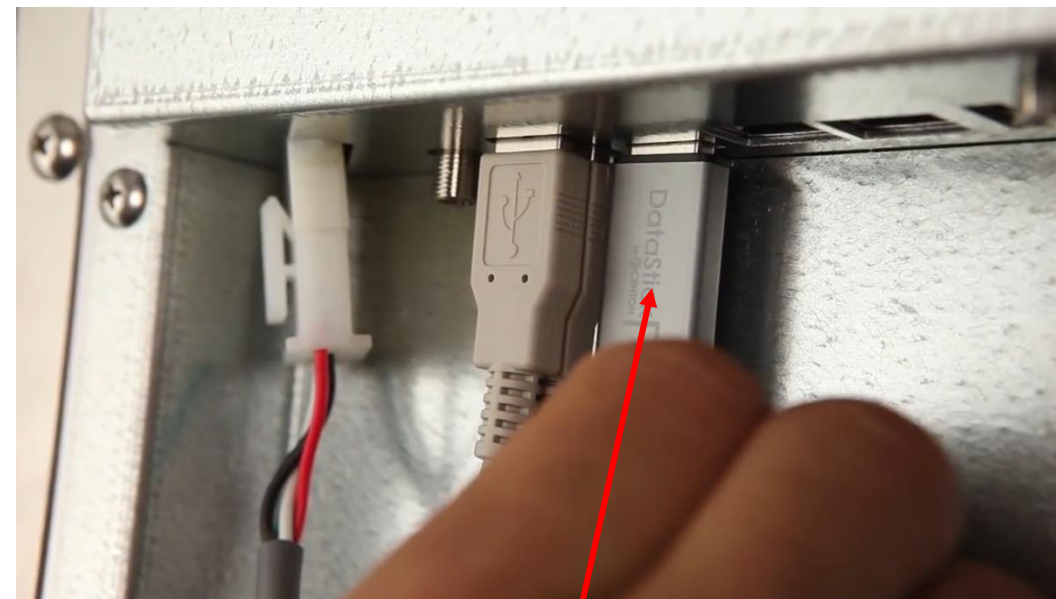

4. Insert USB with new software into the open USB port.



# Software Update Cont.

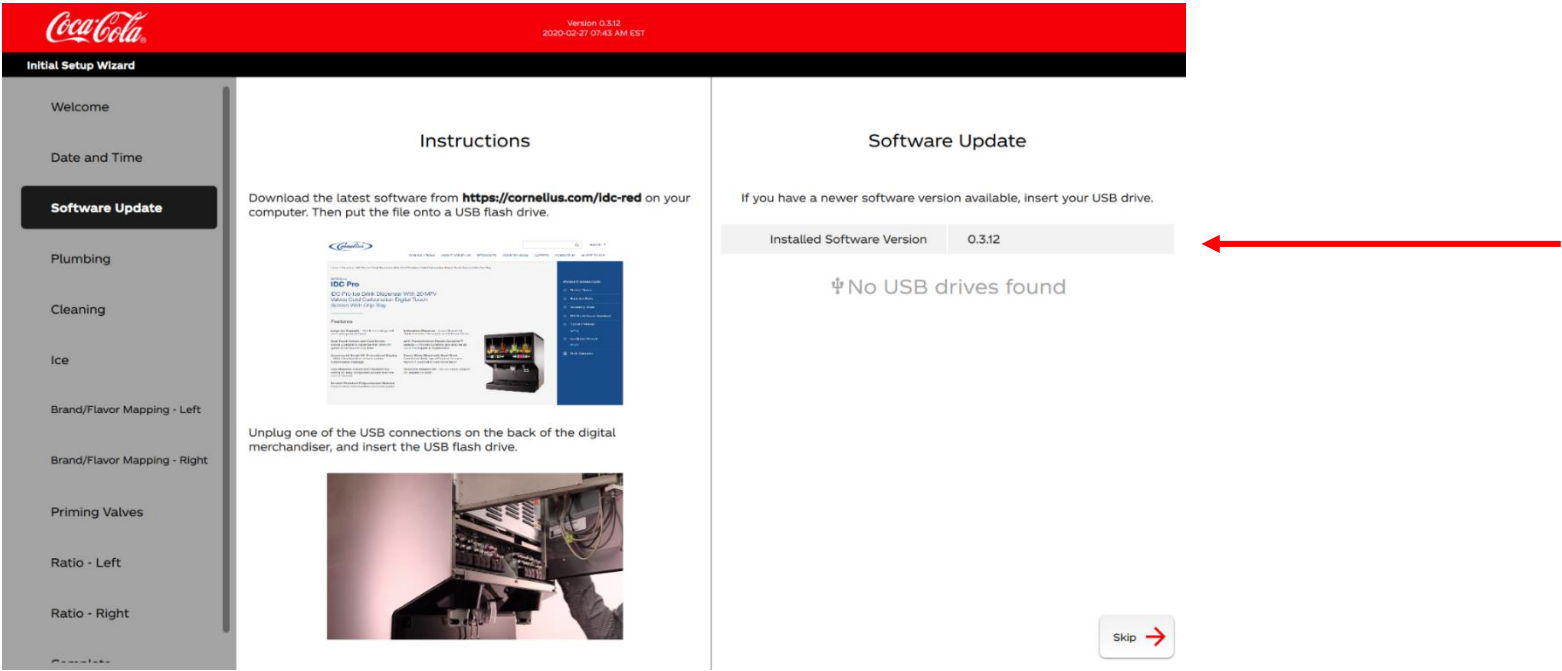

5. Look under SOFTWARE UPDATE. If a newer version of the software is found, it will be the only software version displayed. If you have multiple software versions on the USB and they are older than the current version on the IDC Red, it will say the machine is already running the latest available software version.
6. Select the RECOMMENDED software version and select INSTALL
7. The Screen will restart and will initiate the installation wizard. Continue walking through the installation wizard to complete the installation.
8. Select SOFTWARE UPDATE and confirm that the installation was successful and the software is up to date.

# Software Update Cont.

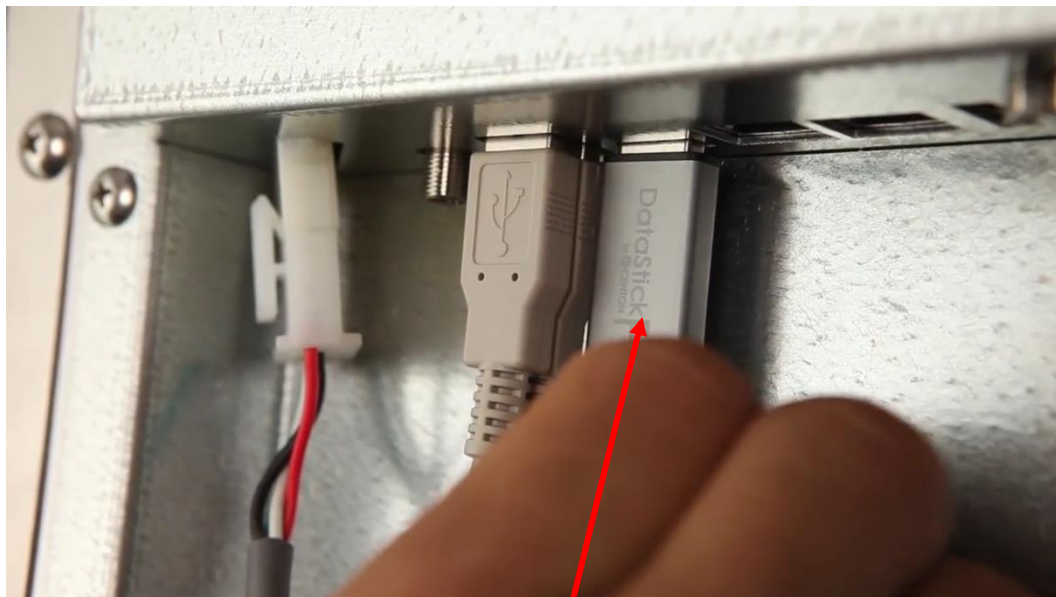

9. Remove the USB and store for future use.

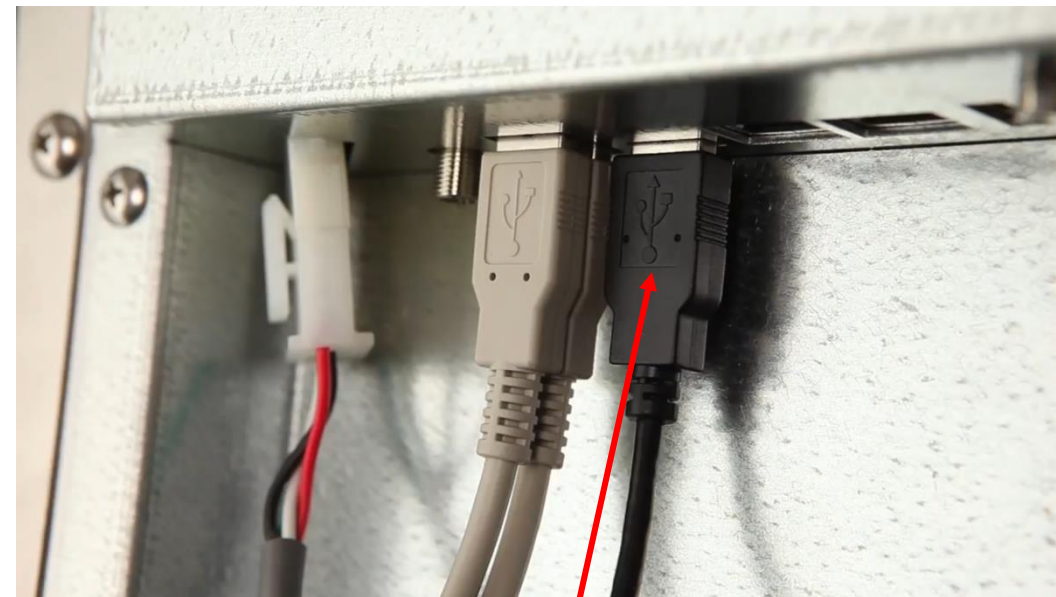

10. Insert ADA USB cable into the open USB port.



# How to Update Software on IDC Red After Installed



A Marmon / Berkshire Hathaway Company





# Tools Needed

- USB with the latest Software version
  - **Note:** it is recommended to have the latest IDC Red software version prior to arriving on site. The latest IDC Red software version can be found at <https://www.cornelius.com/IDC-Red/>. Download the latest software version and transfer to a USB. Do not open the file, copy from recent downloads and paste to your USB or click and drag from recent downloads to your USB.



# Entering the NCUI (Service Screen) prior to 0.3.12



1. Tap the screen anywhere to view beverage selections.



2. To access NCUI prior to software version 0.3.12, press and hold at the bottom, center of the screen where the video and drink selection screen meet. A red square will start to appear and will become darker the longer you hold it. Hold it until a keypad pops up.

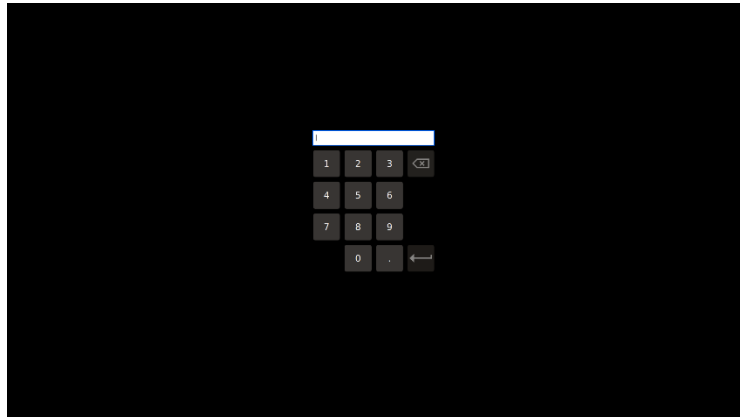

3. Enter the technician level: 2653

# Entering the NCUI (Service Screen) 0.3.12 or Above



1. Tap the screen anywhere to view beverage selections.

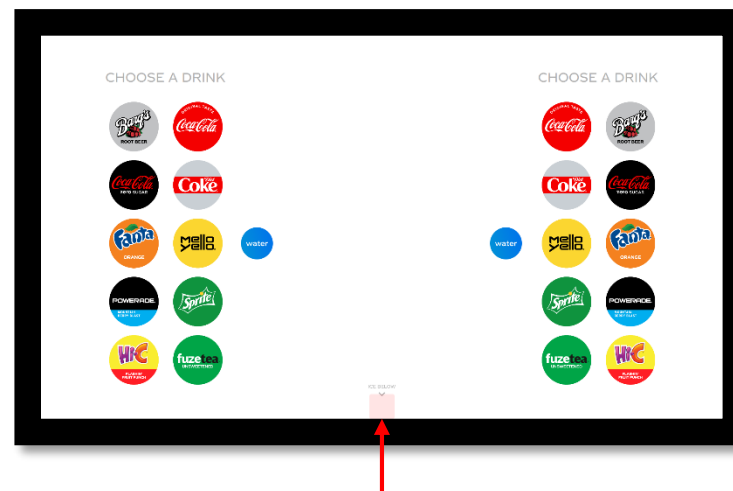

2. To access NCUI on software version 0.3.12 or above, press and below ICE BELOW. A red square will start to appear and will become darker the longer you hold it. Hold it until a keypad pops up.

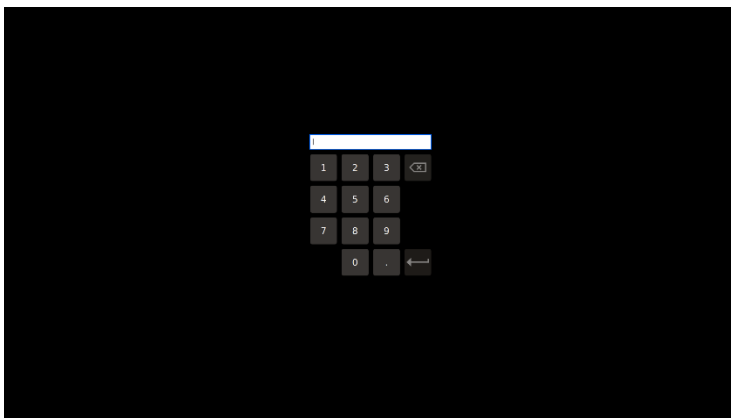

3. Enter the technician level: 2653



# Software Update Cont.

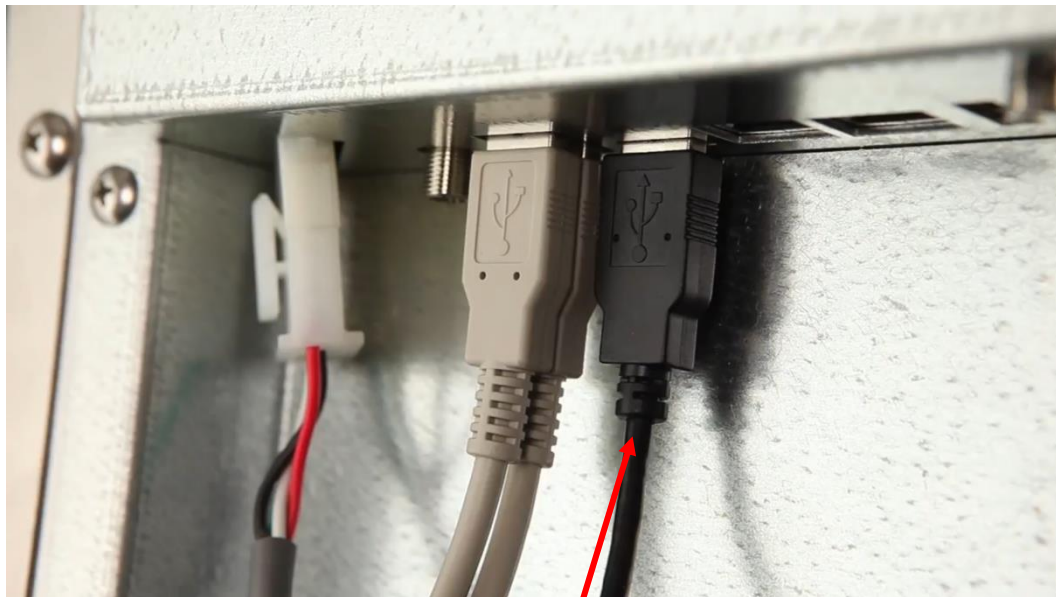

1. Remove the ADA USB cable. Note: there will be three black USB cables. The ADA USB cable will have a yellow stripe around it.

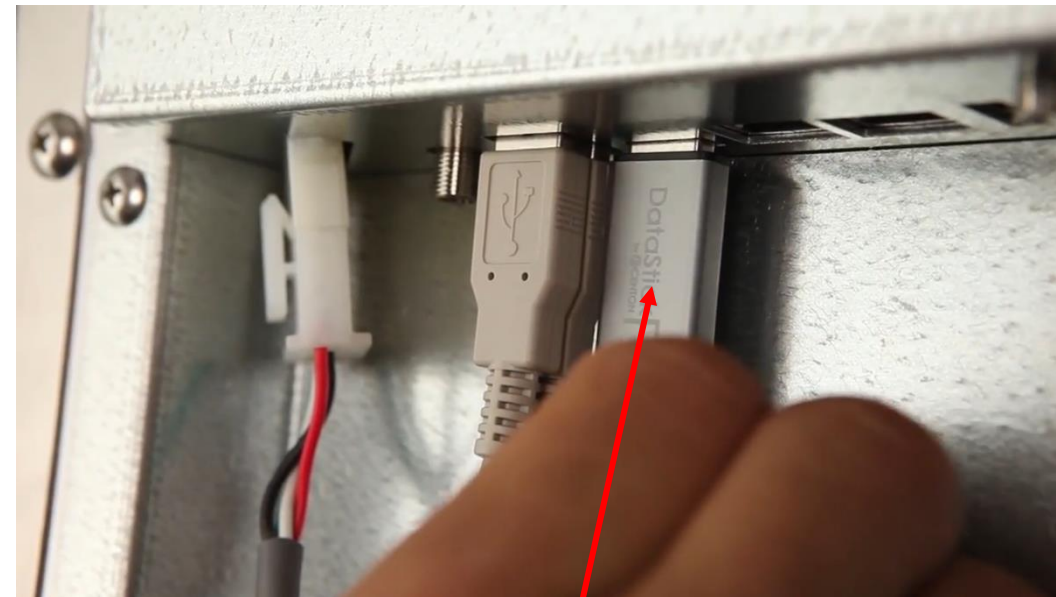

2. Insert USB with new software into the open USB port.



# Software Update

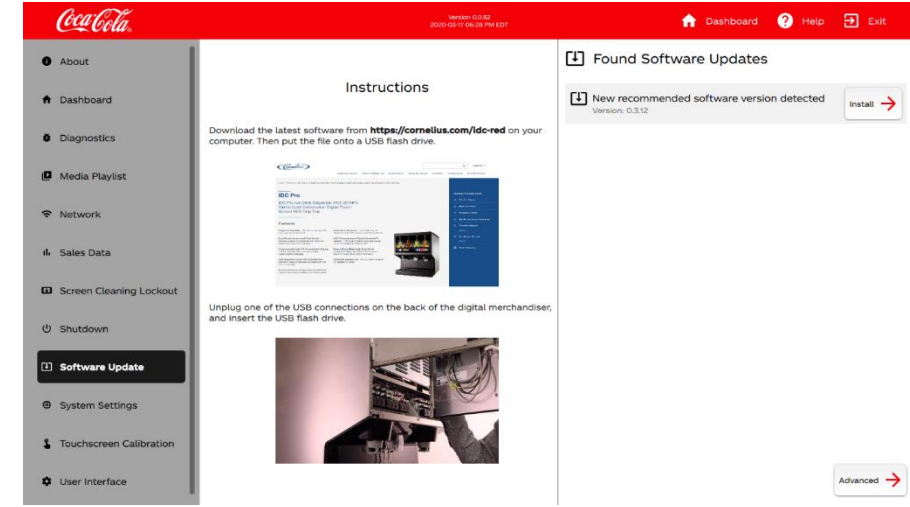
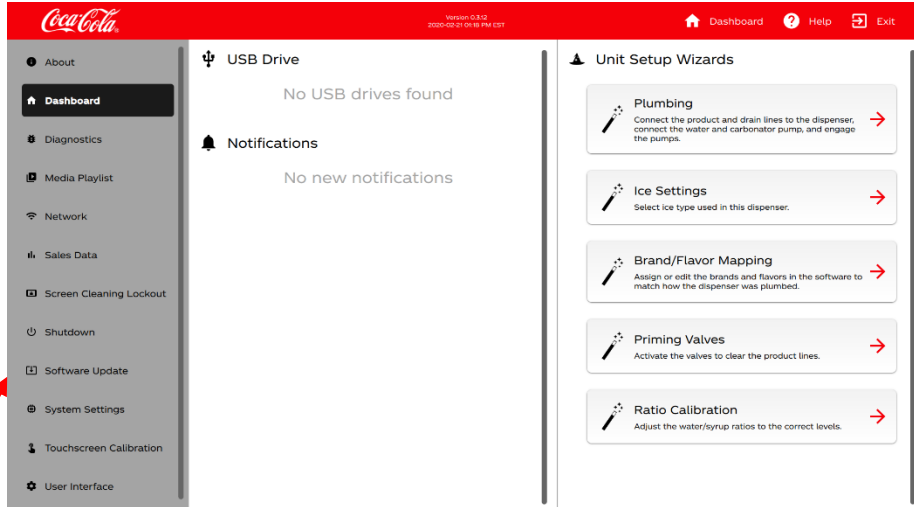

1. Select SOFTWARE UPDATE
2. Look under SOFTWARE UPDATE. If you have multiple IDC Red software versions on the USB you will see multiple versions appear. The latest version will be recognized and will say RECOMMENDED next to it.
3. Select the RECOMMENDED software and select INSTALL
4. The Screen will restart and the main screen will appear.
5. Enter the NCUI and confirm that the software is up to date.



# Software Update Cont.

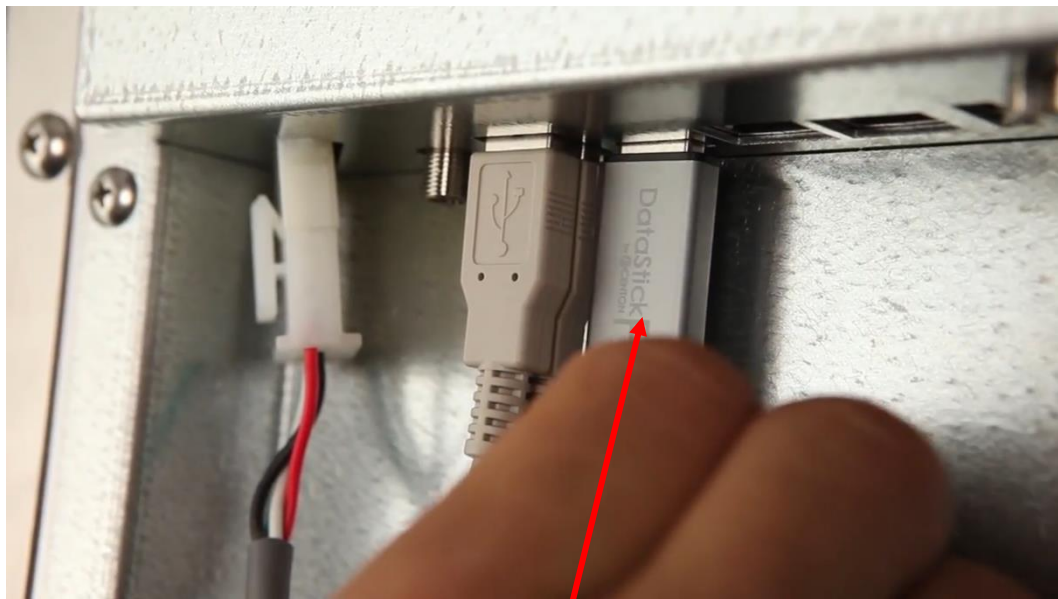

6. Remove the USB and store for future use.

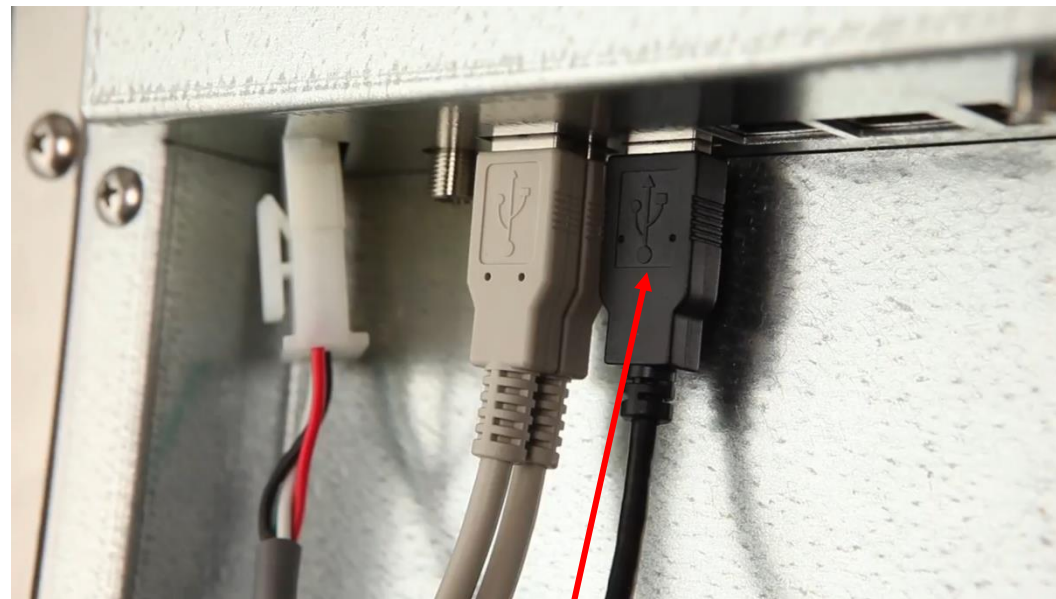

7. Insert ADA USB cable into the open USB port.



# Ratio Calibration (If Needed)

**Note: If you are updating from 0.0.52 or below, you must complete the next four slides . YOU WILL NOT HAVE TO DO THIS IF UPDATING FROM 0.3.12 AND ABOVE OR IF YOU UPDATED SOFTWARE DURING INSTALLATION**

The screenshot shows the Coca-Cola dispenser control interface. At the top, there is a red header with the Coca-Cola logo on the left, the version '0.3.12' and date '2020-02-21 01:18 PM EST' in the center, and navigation icons for 'Dashboard', 'Help', and 'Exit' on the right. A grey sidebar on the left contains a menu with items: About, Dashboard (highlighted), Diagnostics, Media Playlist, Network, Sales Data, Screen Cleaning Lockout, Shutdown, Software Update, System Settings, Touchscreen Calibration, and User Interface. The main content area is divided into three sections: 'USB Drive' (No USB drives found), 'Notifications' (No new notifications), and 'Unit Setup Wizards'. The 'Unit Setup Wizards' section contains five wizard cards: 'Plumbing', 'Ice Settings', 'Brand/Flavor Mapping', 'Priming Valves', and 'Ratio Calibration'. The 'Ratio Calibration' card is highlighted with a red border and a red arrow pointing to it from the right. Each wizard card includes a wand icon, a title, a brief description, and a red arrow icon.

# Setting CW Water Ratio

Coca-Cola
Version 0.312  
2020-02-27 07:52 AM EST

Initial Setup Wizard

Software Update

Plumbing

Cleaning

Ice

Brand/Flavor Mapping - Left

Brand/Flavor Mapping - Right

Priming Valves

Ratio - Left

CW1

PW1

A1

### Ratio Instructions

Position the water chamber of the ratio cup under the left nozzle and tap pour. The dispenser will pour for **4 seconds**.

- Tap ratio cup on counter 3 times, place on level surface, and read immediately.
- Adjust the indicated flow control with a Phillips head screw driver, 1/4 turn at a time, until a **10 oz (284 ml)** pour is achieved for 2 consecutive tests.
- Rinse and dry the cup for each test.

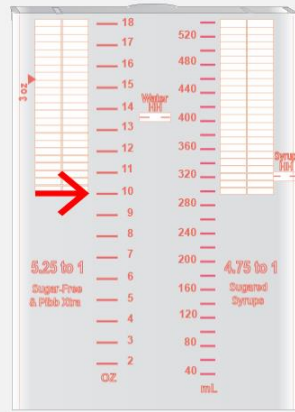

↻ If **above** 10 oz,  
rotate **counter-clockwise**

↻ If **below** 10 oz,  
rotate **clockwise**

Last check: 2020-1-23



POUR

Carbonated Water

CW1

Next →



# Setting PW Water Ratio

Coca-Cola
Version 0.312  
2020-02-27 07:52 AM EST

Initial Setup Wizard

Software Update

Plumbing

Cleaning

Ice

Brand/Flavor Mapping - Left

Brand/Flavor Mapping - Right

Priming Valves

Ratio - Left

CW1

PW1

A1

### Ratio Instructions

Position the water chamber of the ratio cup under the left nozzle and tap pour. The dispenser will pour for **4 seconds**.

- Tap ratio cup on counter 3 times, place on level surface, and read immediately.
- Adjust the indicated flow control with a Phillips head screw driver, 1/4 turn at a time, until a **10 oz (284 ml)** pour is achieved for 2 consecutive tests.
- Rinse and dry the cup for each test.

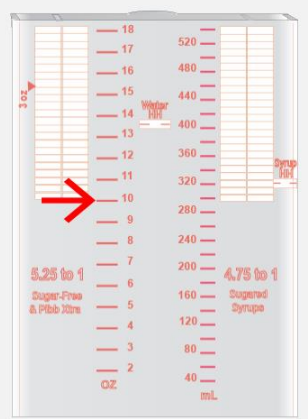

↻ If **above** 10 oz,  
rotate **counter-clockwise**

↻ If **below** 10 oz,  
rotate **clockwise**

Last check: 2020-1-23

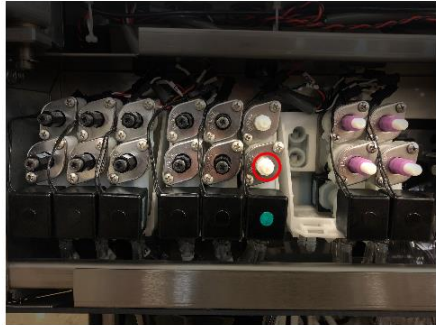

POUR

Plain Water

PW1

Next →

# Setting Syrup Ratios

**Ratio Instructions**

Position the syrup chamber of the ratio cup under the left nozzle and tap pour. The dispenser will pour for **5.7 seconds**.

- Tap ratio cup on counter 3 times, place on level surface, and read immediately.
- Adjust the indicated flow control with a Phillips head screw driver, 1/4 turn at a time, until a **3 oz (85 ml)** pour is achieved for 2 consecutive tests.
- Rinse and dry the cup for each test.

**Measurement Scale:**

18	520
17	480
16	440
15	400
14	360
13	320
12	280
11	240
10	200
9	160
8	120
7	80
6	40
5	
4	
3	
2	
1	
0Z	0 mL

5.25 to 1 Sugar-Free & Pibb 30mL      4.75 to 1 Sugared Syrup

**Control Panel:**

- Default Ratio: 4.75:1
- High Yield: No
- Buttons: Edit, Next

1. Select the brand / flavor shot that you would like to Ratio

# How To Edit Syrup Ratios

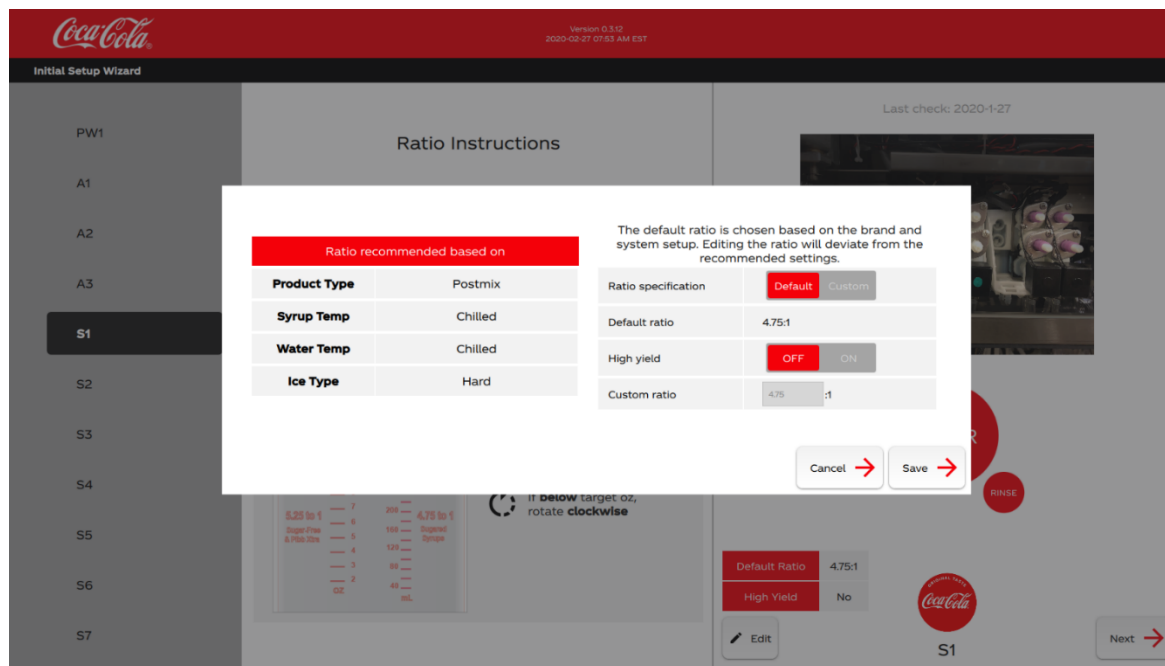

2. Select EDIT
3. Select Default
4. Select HY if the account is using HY syrup
5. Select SAVE
6. Check ratios and adjust if needed
7. Repeat for each Brand and Flavor Shot